



Tractor Chassis 4x2

Series

FT CF85.340 FT CF85.380
FT CF85.430

GVM max. 17400 kg²⁾

Engine : XE 250 / XE 280 / XE 315 Euro III version

Gross Combination Mass¹⁾ : up to 45000 kg

Weights in Kilograms Model	Gross Design Vehicle Mass ²⁾			Chassis and Cab Weight			Gross Design Carrying Capacity		
	Front	Rear	Total	Front	Rear	Total	Front	Rear	Total
Day Cab									
FT CF85...325	6500	10900	17400	4336	1694	6030	2850	10775	13625
FT CF85...360	6500	10900	17400	4346	1711	6057	2840	10760	13600
FT CF85...380	6500	10900	17400	4356	1721	6077	2830	10750	13580
Sleeper Cab									
FT CF85...325	6500	10900	17400	4441	1694	6135	2740	10775	13515
FT CF85...360	6500	10900	17400	4451	1711	6162	2730	10760	13490
FT CF85...380	6500	10900	17400	4461	1721	6182	2720	10750	13470

Chassis and Cab Weight calculated with: F230 tilt Day Cab, with 4 coil spring suspension, XE 315 engine, 2 x 175 Ah batteries, 16 S 181 gearbox, SR 1347 rear axle, 152N front axle, 260 x 75 x 6 mm chassis height, parabolic type springs at front, 4 bag air suspension at rear, shock absorbers and stabilizer at front and rear, 1 x 430 litre aluminium fuel tank, Alcoa aluminium wheels 295 / 80 R 22.5 tyres, front axle, 11 R 22.5 rear axle. All further equipment mentioned as standard.

Note: Chassis / cab weight with sleeper cab plus 105 kg, with Space Cab plus 180 kg. All weights quoted are subject to a +/- 2% variability.

Dimensions in metres

WB	TL	VA	AE ³⁾	AC	CB	CA	CE	CH ⁴⁾	HV ⁵⁾	HA ⁶⁾	RB	SB	TB
Day Cab													
3.25	5.47	1.38	0.84	0.39	0.24	2.62	3.46	1.96	0.90	0.96	0.79	1.82	2.49
3.60	5.82	1.38	0.84	0.39	0.24	2.97	3.81	1.96	0.90	0.96	0.79	1.82	2.49
3.80	6.02	1.38	0.84	0.39	0.24	3.17	4.01	1.96	0.90	0.96	0.79	1.82	2.49
Sleeper Cab													
3.25	5.47	1.38	0.84	0.82	0.24	2.19	3.03	1.96	0.90	0.96	0.79	1.82	2.49
3.60	5.82	1.38	0.84	0.82	0.24	2.54	3.38	1.96	0.90	0.96	0.79	1.82	2.49
3.80	6.02	1.38	0.84	0.82	0.24	2.74	3.58	1.96	0.90	0.96	0.79	1.82	2.49
Space Cab													
3.25	5.47	1.38	0.84	0.82	0.24	2.19	3.03	2.64	0.90	0.96	0.79	1.82	2.49
3.60	5.82	1.38	0.84	0.82	0.24	2.54	3.38	2.64	0.90	0.96	0.79	1.82	2.49
3.80	6.02	1.38	0.84	0.82	0.24	2.74	3.58	2.64	0.90	0.96	0.79	1.82	2.49

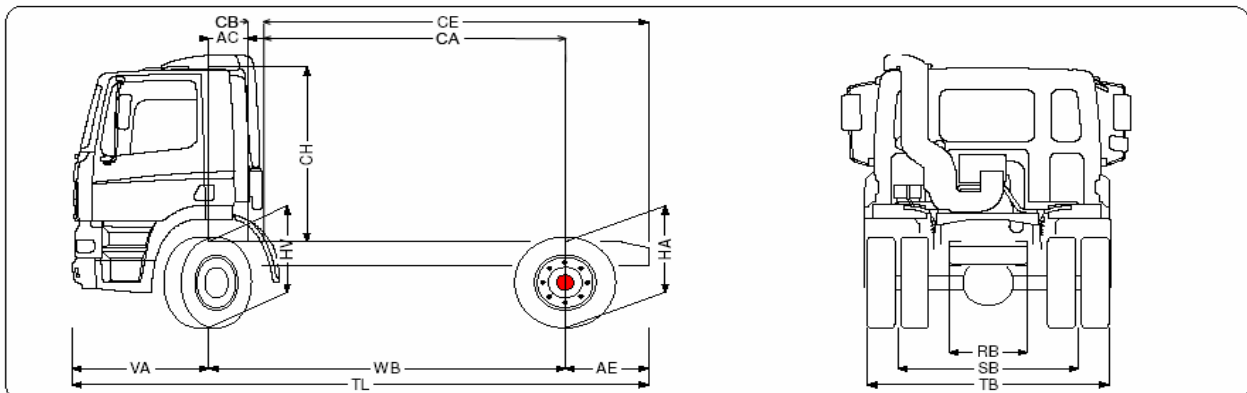

- 1) Subject to application approval.
- 2) Front axle load based on tyre load index (7100 / 12600)
- 3) AE with leaf suspension: 1.01 m
- 4) CH with air intake on cab roof: + 0.14 m, with Space Cab: + 0.68 m
- 5) Laden height at centre of front axle.
- 6) Laden height at centre of rear axle.

ENGINE

General: 6 cylinder, 24 valves.
Piston displacement: 12.6 litres.
Compression ratio: 17.4 to 1.
Governor: Electronically controlled. (UPEC).
Type: **XE 250 C Euro III.**
Max. output: 250 kW / 340 hp at 1900 rpm.
Max. torque: 1600 Nm / 1180 lbft at 1000 – 1500 rpm.
Type: **XE 280 C Euro III.**
Max. output: 280 kW / 380 hp at 1900 rpm.
Max. torque: 1750 Nm / 1290 lbft at 1000 – 1500 rpm.
Type: **XE 315 C Euro III.**
Max. output: 315 kW / 430 hp at 1900rpm.
Max. torque: 1950 Nm / 1440 lbft at 1000 – 1500 rpm.
Maximum output and torque according ECE R24-03 (ISO 1585).

CHASSIS

Completely flat-topped chassis frame. Riveted and bolted construction of channel-section main frame members (tapered at the rear end) and cross members. Catwalk behind the cab.
430-litre aluminium fuel tank.
Main frame members with angle sections for mounting of fifth wheel.
Horizontal box type exhaust silencer at RHS with vertical pipe. Side marker lamps.
Dimensions main frame members: 260 x 75 x 6 mm, or 260 x 75 x 7 mm with front inner reinforcement.

GEARBOX

8 S 151 / 181: 4-speed main gearbox with range-change group giving 8 speeds.
16 S 151 / 181: 4-speed main gearbox with splitter group and range-change group giving 16 speeds.
12 AS 1930 / 2140: 12 speed, automated manual, AS Tronic transmission.

	XE 250	XE 280	XE 315
8 S 151 (13.86 - 1.00) and 16 S 151 (16.47 - 1.00)	X	-	-
8 S 181 (13.80 - 1.00) and 16 S 181 (16.41 - 1.00)	-	X	X
12 AS 1930 (15.86 - 1.00)	-	X	-
12 AS 2140 (15.86 - 1.00)	-	-	X

CLUTCH

Single type, pulled operation, asbestos free, dry plate, hydraulically operated and pneumatically assisted, with servoshift.
Diameter: 430 mm.

FRONT AXLE

Type: **152N.**
Max. design load: 7500 kg.
I-section axle. Stub axles with needle bearings.

Optional:

Type: **156N.**
Max. design load: 7500 kg (straight beam).

REAR AXLES

Type: **SR 1347.**
Max. design load: 13000 kg.
Single reduction driven axle with diff lock.

Optional:

Type: **HR 1354.**
Max. design load: 13000 kg (hub reduction).

FRONT SUSPENSION

Parabolic type leaf springs with shackled ends at rear.
Shock absorbers and stabilizer bar.

REAR SUSPENSION

DAF 4 bag (13000 kg) air suspension.
Shock absorbers and stabilizer bar.

Optional:

Type: Parabolic type leaf springs with shackled ends at rear.

WHEELS AND TYRES

22.5" (10 stud) aluminium disc wheels, with 295 / 80 R 22.5 tubeless radial type tyres at front 11 R 22.5 dual tyres at rear.

Optional:

- Steel disc wheels. - Wheel protection rings.

STEERING

Type: Hydraulic power steering with steering column adjustable for rake and height.

	Between kerbs	Between walls
Turning circle		
WB 3.25 m	11.95 m	13.35 m
WB 3.60 m	12.85 m	14.30 m
WB 3.80 m	13.35 m	14.80 m

(All given turning circles are under reservation).

BRAKE SYSTEM

Electronically controlled, dual-circuit air operated disc brakes with wear indicators at front and rear (HR 1354 with drum brakes).
Asbestos free brake pads. Electronic Brake System (EBS) with ABS.
DAF Engine Brake (DEB).

Parking brake: Pneumatically operated by means of spring brake actuators on driven rear axle.

Optional:

- ZF Intarder. - ASR.
- VSC (stability control).

ELECTRICAL EQUIPMENT

Voltage: 24 V
Alternator: 80 A
Batteries: 2 x 175 Ah

Optional:

- 225 Ah batteries. - 100 A alternator.

TRAILER EQUIPMENT

- Semi-trailer brake connectors: 2-line with suzi couplings.
- Two 7-pole semi-trailer connector for lights (12 V + 24V), and one 5-pole (12V) connector for ABS.
- Light, accessories and ABS connecting cables.

Optional:

- Rear towing hook (D = 4.3).

CAB EXTERIOR

- F230 tilt Day Cab with 4 coil spring suspension and hydraulic tilting device.
- Tilting angle 57.5°.
- Fixed, illuminated cab steps. - Vehicle immobiliser.
- Manually controlled roof hatch with reinforced glass.
- Heated main and wide angle mirrors.
- Steel front bumper with foot hold.
- Permanent driving lights. - External sun visor.
- Electric adjustable main mirrors.
- Corner air deflectors. - Side collars.

Optional:

- Sleeper Cab. - Space Cab.
- Aluminium roof hatch. - Tinted glass.
- Side window on sleeper cab. - Non-translucent roof hatch.
- Alarm. - Hazard beacon lights.
- Spot lights. - Rear window.
- FUPS.

Aerodynamics Optional:

- Adjustable roof spoiler.

COLOURS

- Choice of 21 basic solid cab colours and 3 chassis colours.
- Various non-standard and metallic cab colours.

CAB INTERIOR

Completely equipped instrument panel. Servoshift gear shift system.
Adjustable air suspended driver seat and fixed co-driver seat with head restraint. Various storage facilities. Sleeper cab with 1 bunk and 2 large storage boxes underneath, left-hand side storage box accessible from the outside. RHD hydraulic power steering, 4 spoke, soft grip steering wheel. Electric window opener. Cruise control. Wood structure dashboard finish. Integrated 3-point safety belt. Air conditioning.

Optional:

- Various driver/co-driver seats. - 2nd bunk on Sleeper Cab and
- 3rd seat (Day Cab). - Space Cab.
- Leather finish steering wheel. - Mechanical or electrical remote controlled door lock.

GENERAL EQUIPMENT

Legal Aspects

- Exhaust emission according to Euro III. - ECE29.
- EEC certified noise encapsulation.

Application Conditions

- Raised air intake on top of the roof. Set of tools. Heated air dryer.

Optional:

- Air intake behind the cab. - Cyclonic type air filter.
- Acoustic reversing signal. - 340 litre aluminium
- Spray suppression at front and fuel tank (depending on WB and
rear. version).
- Spare wheel carrier with winch. - Catwalk extension.
- Component free LHS.

MAX. SPEED

Theoretical max. speed in km/h at 1900 rpm with 11 R 22.5 tyres.

Ratios, SR 1347 axle	2.93	3.07	3.31	3.73	4.10
Direct drive	-	118	110	97	89

Ratios, HR 1354 axle	4.12	4.46
Over drive	105	97

Max. speed depending on gear ratios, tyres, superstructure, GCM and operating conditions. Road speed limited to 100 km/h.

DAF Trucks Australia

A DIVISION OF **PACCAR AUSTRALIA PTY LTD**
ACN 004 669 667 ABN 14 004 669 667

355 Fitzgerald Road, Derrimut
Victoria 3030 Australia
Telephone: (03) 9396 9100 Fax: (03) 9396 9140

The vehicle depicted in this publication is for illustrative purposes only and may include some non standard items. DAF Trucks Australia reserves the right to change these specifications without notice.